

Protective Plug

Feature : Explosion-proof Protective Plugs are used to close unused cable entries, and can also be used as transport plugs to prevent moisture and dirt from entering the finished product during transportation. Protective Plugs are installed in the sealing ring of the cable entry. Scope - underground workings of mines and mines, dangerous for gas (methane), coal dust; explosive zones of rooms and outdoor installations according to explosion protection marking, GOST 30852.13-2002 (IEC 60079-14: 1996), hazardous industrial facilities of I, II, III, IV hazard classes.

Ambient Temperature : -60° C to +125° C

Protection : IP66/67

Material : Plastic, Nickel Plated Brass

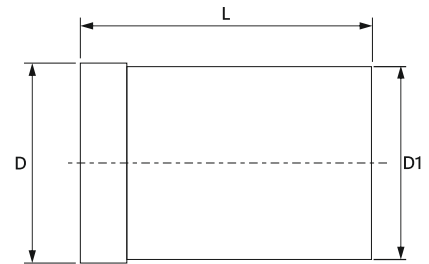
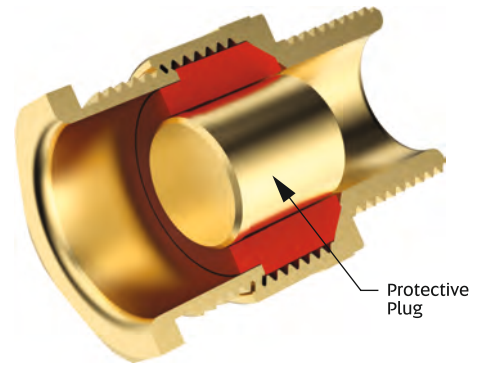

PROTECTIVE PLUGS

Code	Size	D	D1	L
EPP-20	20	14.1	13.5	15.00
EPP-25	25	20.1	19.5	15.00
EPP-32	32	26.3	25.7	15.00
EPP-40	40	32.5	31.6	15.00
EPP-50	50	44.3	43.5	15.00
EPP-63	63	56.1	55.5	15.00